



Welcome

We are starting soon...

Webinar WE6:

**COPRA[®] RF 2011 –
Cloned Rolls**



data M
Sheet Metal
Solutions

The sound is carried over the internet. In order to hear the presenter please include a set of headphones or speakers at your computer.

Content

- Clone Rolls – Terms and Definitions
- Automatic and manual clone functions
- Material lists / roll drawings
- Benefits of cloning rolls
- View of the roll database

Clone rolls – Terms and Definition

To **Clone rolls** means, that the geometry and the attributes of the rolls are **associatively linked**.

Clone rolls – Terms and Definitions

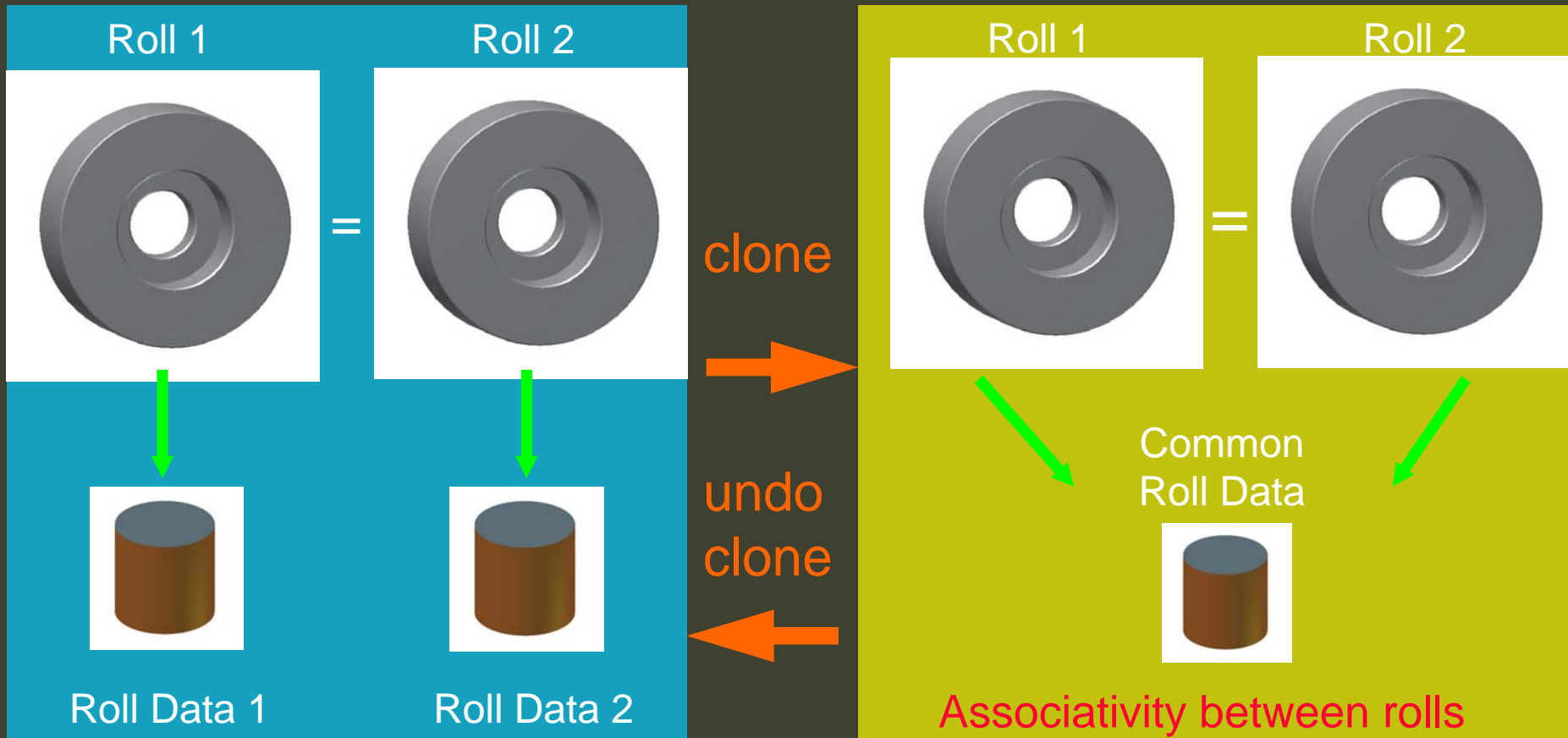

Automatic und manual clone functions (group A)

- Clone rolls manually in current pass
- Clone selected roll in current pass
- Clone one roll automatically in current pass
- Clone all rolls automatically in current pass
- Clone one roll automatically in range of selected passes



in one station

over all stations

Automatic und manual clone functions (group A)

- Copy roll(s) to the clipboard
- Assign clone information to a roll
- Scroll backwards
- Scroll forward
- Cancel

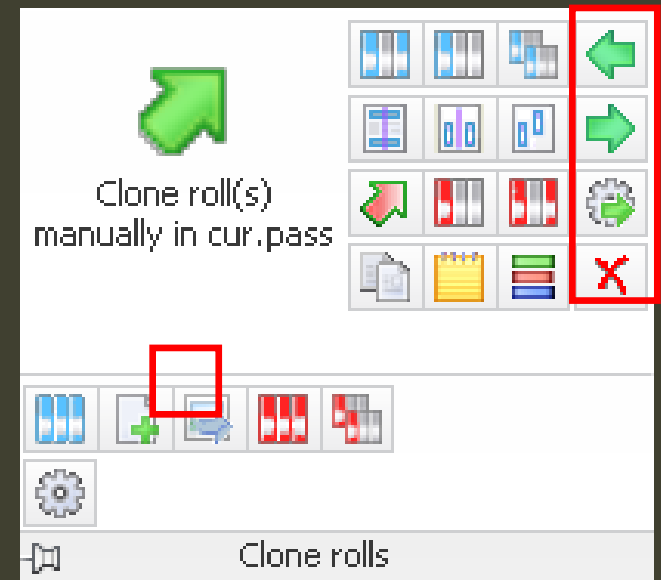

Automatic und manual clone functions (group B)

- Mirror and clone complete tool
- Mirror and clone individual rolls
- Mirror and copy individual rolls
- Move clones position variant in pass
- Copy roll(s) to the clipboard

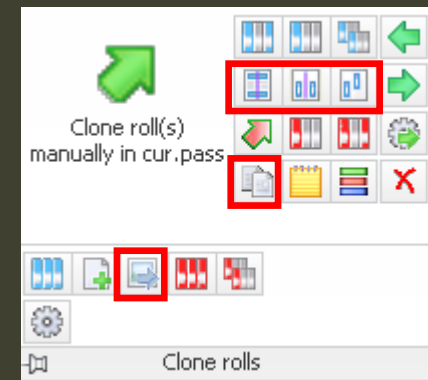

in one station

over all stations

Automatic und manual clone functions (group C)

- Release a clone manually
- Release a clone automatically in current pass
- Release selected clones automatically in current pass
- Release all clones automatically in current pass
- Release all clones automatically in pass selection

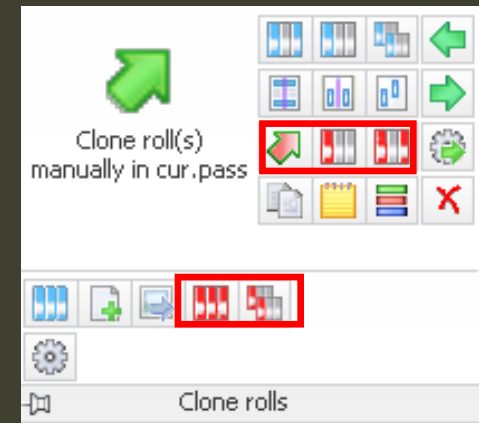

in one station

over all stations

Automatic und manual clone functions

- Cross reference for clones
- Modify colours
- Adjust settings

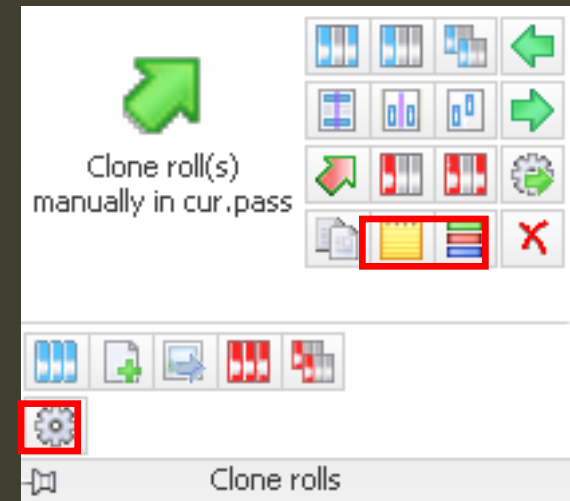

Automatic und manual clone functions - settings

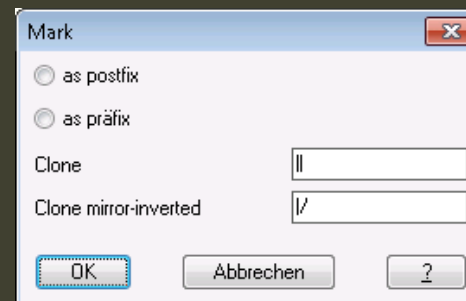
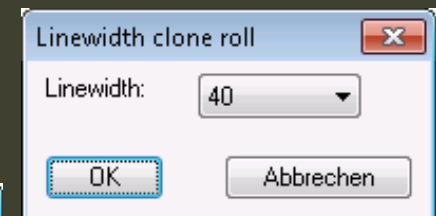
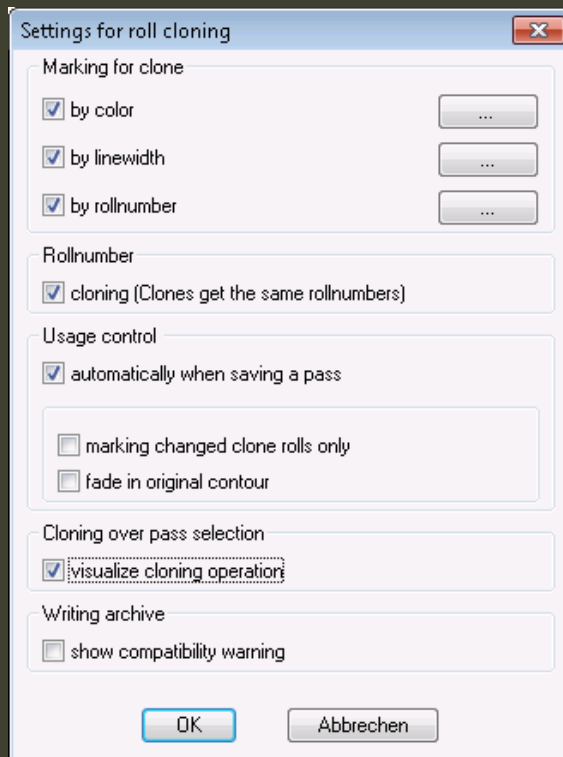

Create Material List

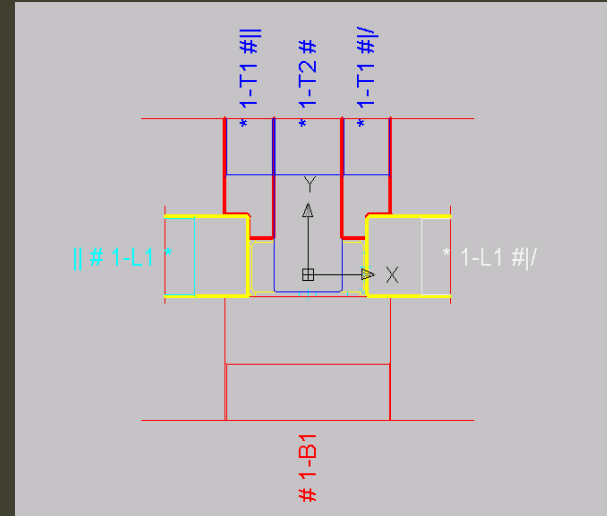
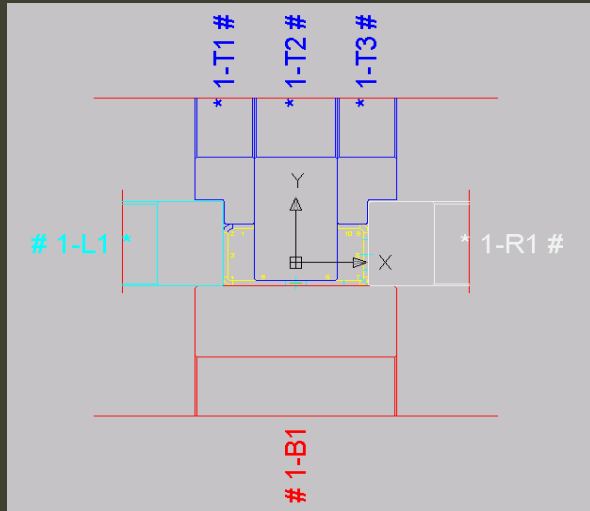

Drag a column header here to group by that column.

Number	Pieces	Rollnumber	Final diameter	Final width	Raw diameter
1	1	1-L1	100.00	45.00	110.00
2	1	1-R1	100.00	45.00	110.00
3	1	1-T1	135.00	29.50	140.00
4	1	1-T3	135.00	29.50	140.00
5	1	1-B1	140.00	100.00	150.00
6	1	1-T2	196.00	41.00	200.00

not cloned

Drag a column header here to group by that column.

Number	Pieces	Rollnumber	Final diameter	Final width	Raw diameter
1	2	1-L1	100.00	45.00	110.00
2	0	1-L1	100.00	45.00	110.00
3	2	1-T1	135.00	29.50	140.00
4	0	1-T1	135.00	29.50	140.00
5	1	1-B1	140.00	100.00	150.00
6	1	1-T2	196.00	41.00	200.00

cloned

Create Roll Drawings

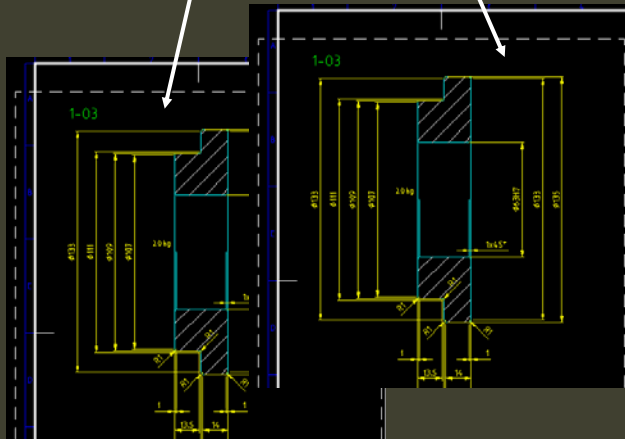
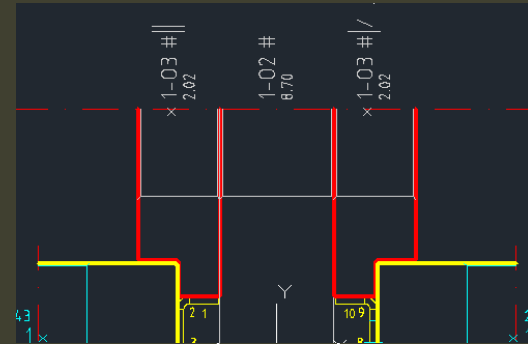
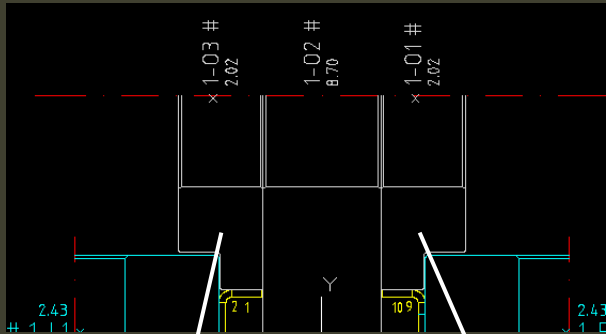

not cloned

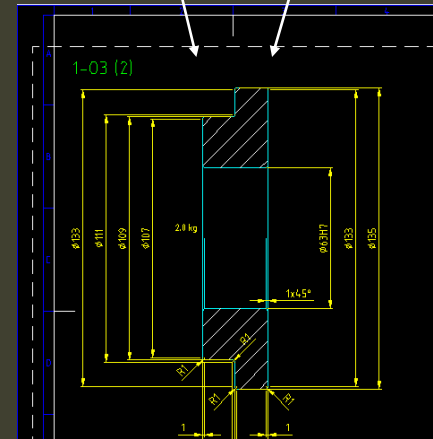

cloned

Benefit of Cloning Rolls

- Changes to the same rolls - one roll only from a clone group needs to be changed (associativity)
- Material list – only one entry for the same rolls
- Material list – number of identical rolls supplied
- Roll drawings – only one drawing for the same rolls

Outlook at the roll database

- Cloning: *NO (!)* Roll Associativity throughout multiple projects
- Database: Roll Associativity throughout multiple projects

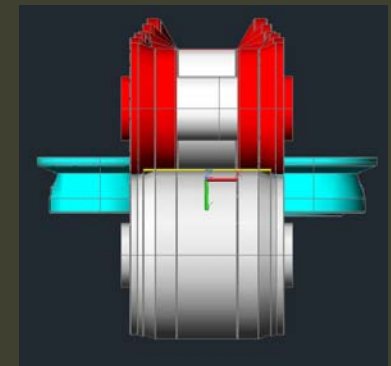
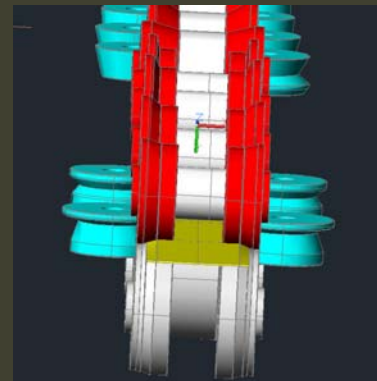
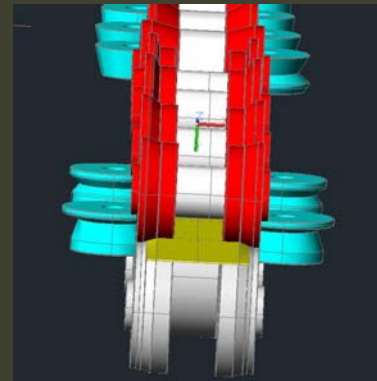

Discussion and questions



Webinars on the Website

Our next webinars

15 December 2011 Category: Webinar English

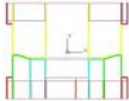
 **WE6: Roll Construction Part2: Clone Rolls and Info parts**
Organizer: data M (UK) Sheet Metal Solutions Ltd.

Time suitable for Middle East / Asia / Australia:
10:00 AM
(UTC+01 Amsterdam, Berlin, Rome, Vienna)

[REGISTER](#)

Time suitable for North / South America:
5:00 PM
(UTC+01 Amsterdam, Berlin, Rome, Vienna)

[REGISTER](#)

26 January 2012 Category: Webinar English

 **WE7: COPRA® RF 2011 Roll Data Base**
Organizer: data M Sheet Metal Solutions GmbH

Time suitable for Middle East / Asia / Australia:
10:00 AM
(UTC+01 Amsterdam, Berlin, Rome, Vienna)

[REGISTER](#)

Time suitable for North / South America:
5:00 PM
(UTC+01 Amsterdam, Berlin, Rome, Vienna)

[REGISTER](#)

www.datam.de

Recorded Webinars

Training & Support

Demo Videos

Recorded Webinars

COPRA® RF Videos

COPRA® RF FEA Videos

COPRA® Metalbender Videos

COPRA® RollScanner Videos

Training

Support

Webinars

COPRA® Software Maintenance

FAQs

WE5 - COPRA® RF 2011 - Roll Construction 1: Free Design and Classic

Name	Content	Video files	Presentation files
<p>WE5: Roll Construction 1: Free Design and Classic</p>  <p>24.11.11</p>	<ul style="list-style-type: none"> Designing rolls using COPRA® classic construction (using COPRA® and AutoCAD) Modifying classically designed rolls using COPRA® roll design modification tools Designing rolls using COPRA® free design functions (using AutoCAD) Modifying free designed rolls using COPRA® roll design modification tools and AutoCAD 	<p>WE5-RollConstruction1.mp4 (67 MB)</p> <p>WE5-RollConstruction1.wmv (63 MB)</p>	<p>WE5-RollConstruction1.pdf (1,3 MB)</p>

WE4 - COPRA® RF 2011 - Crimps, Claws and Holes

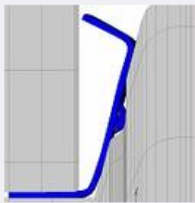
Name	Content	Video files	Presentation files
<p>WE4: Crimps, Claws and Holes in COPRA® RF 2011</p>  <p>27.10.2011</p>	<ul style="list-style-type: none"> Creating a Crimp & Claw Viewing Embossing In Roll Design Creating Holes Within COPRA® RF 2011 Using Holes From The Library Automatically Taking Holes To Our FEA Mesh 	<p>WE4-CrimpsClawsHoles.mp4 (43 MB)</p> <p>WE4-CrimpsClawsHoles.wmv (48 MB)</p>	<p>WE4-CrimpsClawsHoles.pdf (1,86 MB)</p>

www.datam.de Videos

Training & Support

Demo Videos

Recorded Webinars

COPRA® RF Videos

COPRA® RF FEA Videos

COPRA® Metalbender Videos

COPRA® RollScanner Videos

Training

Support

Webinars

COPRA® Software Maintenance

FAQs

COPRA® RF 2011 - Trapezoidal Flower Tool

Video Name

NEW

CORPA® RF 2011- Trapezoidal Flower Tool

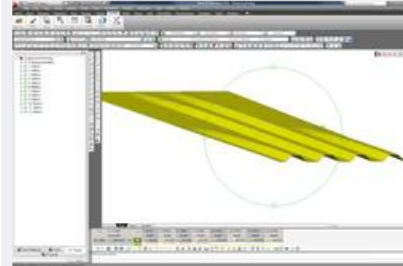

Topics

- Trapezoidal Profile Creation
- Automatic Unfolding
- Creating Trapezoidal Bending Sequence
- Show 3D Modell

Video File

[Trapezoidal Flower Tool-CRF2011.mp4](#)
(13,1 MB)

Length: 12,14 min.
Language: English

Online Trainings



- Save time
- Save money

Thank you for your attention!

Goodbye...

Webinar WE6:
**COPRA[®] RF 2011 –
Cloned Rolls**



data M
Sheet Metal
Solutions